

## Stringibarra Wickman

Codice	Descrizione	d	D	L	a	F	Tondo max	Esagono max
9014E	5/8"	29.4	38.1	92.0	15°	Ø26,21 X 24	17.0	15.0
9034E	1"	41.3	54.5	132.0	15°	Ø37,8 X 24 Sin.	30.0	24.0
PIWOVE	1" Oversize 30mm.	49.21	60.72	110.0	15°	M44.2X1 Sin.	34.0	28.0
9072E	1 3/8"	55.47	67.0	117.0	15°	Ø50,927 X 22 Sin.	41.0	34.0
9111E	1 3/4"	64.21	78.5	127.0	15°	Ø60,45 X 16 Sin.	46.0	40.0
9142E	2 1/4"	76.86	95.5	181.0	15°	Ø72,46 X 22 Sin.	62.0	53.0
9181E	2 5/8"	92.07	111.0	165.0	15°	Ø85,72 X 18	77.0	65.0

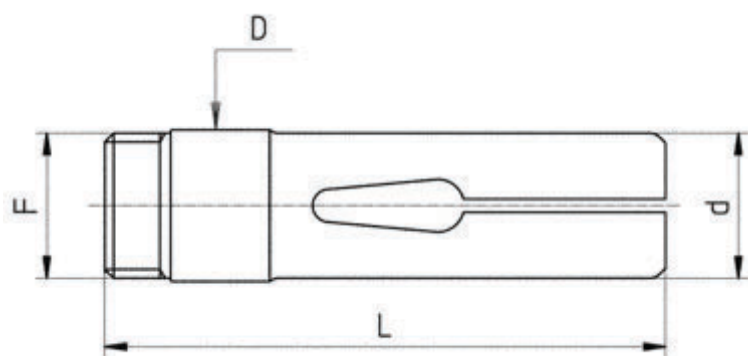

## Spingibarra Wickman

Codice	Descrizione	d	D	L	F	Tondo max	Esagono max
9260E	5/8"	21.6	21.6	86	Ø19,53 X 24 Sin.	16.0	13.0
9276E	1"	31.0	31.9	133	Ø30,07 X 24 Sin.	26.0	22
9318E	1 3/8"	41.5	42.84	118	Ø40,46 X 22 Sin.	36.0	31.0
9362E	1 3/4"	51.5	52.21	127	Ø49,98 X 22 Sin.	44.0	38.0
9409E	2 1/4"	64.3	65.1	171	Ø62,509 X 22 Sin.	57.0	49.0
9445E	2 5/8"	74.0	76.0	179	Ø73 X 24 Sin.	66.0	47.0